



Application:

Container discharge, especially for bulky material on transport trucks. Easy mounting on molds for concrete compaction or on machine parts to vibrate bulk material, on hoppers or silos.

Type	Unbalance [cmkg]	Long term operation ED 100%			Short term operation ED ≤ 60%			Weight [kg]
		Frequency [U/min]	Centrifugal force [N]	Flow [l/min]	Frequency [U/min]	Centrifugal force [N]	Flow [l/min]	
NHG 500 L	2,06	6.000	4.070	12	7.000	5.550	14	6,4
NHG 600 R L	3,00	6.000	5.922	12	7.000	5.723*	14	8,2
NHG 900 L	6,64	4.000	5.870	8	5.000	9.100	10	7,7
NHG 3000 L	29,18	3.500	19.600	20	4.000	25.600	22	29,0

*) In this case the unbalance must be reduced to 2,19 cmkg.

Type	Operating pressure inlet [bar]	Oil temperature [°C]	Ambient temperature [°C]
NHG 500 L	200	-15 to 90	-20 to 80
NHG 600 R L	200	-15 to 90	-20 to 80
NHG 900 L	200	-15 to 90	-20 to 80
NHG 3000 L	300	-15 to 90	-20 to 60

The NHG 500 L, NHG 900 L and NHG 3000 L have fixed unbalances.

Type NHG 600 R L (reversible) has an unbalance that can be adjusted in steps. Adjustment of the unbalance is accomplished from outside, no opening of covers required. Adjustable unbalance and larger types of vibrators on request.

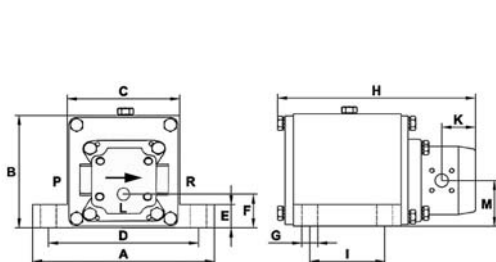

NHG 500 L, NHG 600 R L and NHG 900 L

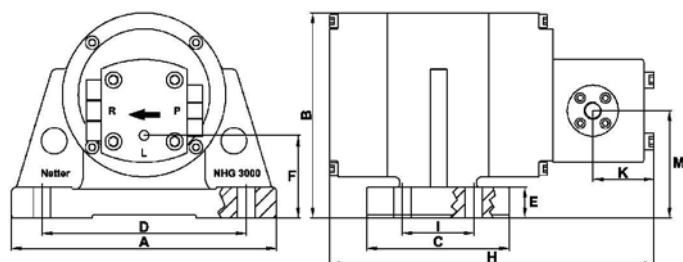

NHG 3000 L

Type	A [mm]	B [mm]	C [mm]	D [mm]	E [mm]	F [mm]	Ø G [mm]	H [mm]	I [mm]	K [mm]	Ø L [mm]	M [mm]	Ø P [mm]	Ø R [mm]
NHG 500 L, NHG 600 R L NHG 900 L	194	120	120	160	24	36	17	212	80	37	G1/4	47	G1/4	G3/8
NHG 3000 L	260	190 (210)	140	200	30	60 (80)	17	320	70	50	M12x1,5	94 (114)	G3/8	G1/2

Our experienced technicians will advise you further.